



**AGENDA PAPERS FOR
LICENSING SUB-COMMITTEE MEETING**

Date: Wednesday, 29 October 2014

Time: 6.30 pm

Place: Council Chamber, Trafford Town Hall, Talbot Road, Stretford,
Manchester, M32 0TH

A G E N D A	PART I	Pages
1.	ATTENDANCES	
	To note attendances, including Officers and any apologies for absence.	
2.	APPLICATION FOR THE GRANT OF A PREMISES LICENCE – COMMUNITYSPORTS HALL AT ALTRINCHAM FOOTBALL CLUB, THE J DAVIDSON STADIUM, MOSS LANE, ALTRINCHAM, CHESHIRE WA15 8AP	1 - 42
3.	APPLICATIONS WITH ALL PARTY AGREEMENT (STANDING ITEM)	
	To receive an update on applications where all parties have reached agreement and to decide, in each case, whether to: Agree that a hearing is not necessary and determine to grant the licence and attach the agreed conditions: or Agree that a hearing will be necessary with all the parties present.	
4.	URGENT BUSINESS (IF ANY)	
	Any other item or items which by reason of special circumstances (to be specified) the Chairman of the meeting is of the opinion should be considered at this meeting as a matter of urgency.	

THERESA GRANT
Chief Executive

Membership of the Committee

Councillors D. Bunting, C. Candish (Chairman) and M. Freeman

Further Information

For help, advice and information about this meeting please contact:

Mrs Ruth Worsley, Democratic Services Officer

Email: ruth.worsley@trafford.gov.uk

This agenda was issued on **Tuesday, 21 October 2014** by the Legal and Democratic Services Section, Trafford Council, Trafford Town Hall, Talbot Road, Stretford M32 0TH..

Any person wishing to photograph, film or audio-record a public meeting are requested to inform Democratic Services in order that necessary arrangements can be made for the meeting

Please contact the Democratic Services Officer 48 hours in advance of the meeting if you intend to do this or have any queries

AGENDA ITEM NO.

TRAFFORD COUNCIL

THE LICENSING SUB-COMMITTEE – 29TH OCTOBER 2014

REPORT OF THE HEAD OF PUBLIC PROTECTION

REPORT REF. NO.

APPLICATION FOR THE GRANT OF A PREMISES LICENCE – COMMUNITY SPORTS HALL AT ALTRINCHAM FOOTBALL CLUB, THE J DAVIDSON STADIUM, MOSS LANE, ALTRINCHAM, CHESHIRE WA15 8AP

PURPOSE

To advise Members of an application for the Grant of a premises licence for the Community Sports Hall at Altrincham Football Club, The J Davidson Stadium, Moss Lane, Altrincham, Cheshire WA15 8AP which has attracted representations from local residents.

OPTIONS

The Sub-Committee to take such steps as they consider necessary for the promotion of the Licensing Objectives in accordance with the provisions of subsection 18(4) of the Licensing Act 2003.

Iain Veitch
Head of Public Protection

Further Information From:

Name: Jan Taylor / Steve Bate
Licensing Officer / Snr Licensing Officer
Extension: 4047 / 4144

Proper Officer for the purposes of L.G.A 1972,S.100D
(background papers): Head of Public Protection

Appendices:

Appendix A - Application and Operating Schedule (including premises layout & location map)

Appendix B – Current Premises Licence PL000461

Appendices C1 to C2 - Representations against application from local residents

Appendix D – Extract of Secretary of States' Guidance: Public Nuisance

Appendix E – Extract of Trafford Council Licensing Policy 2011–2014: Public Nuisance

1. Background

- 1.1 The subject of this application is the premises known as Altrincham Football Club at The J Davidson Stadium, Moss Lane, Altrincham, Cheshire WA15 8AP.
- 1.2 A new purpose built Community Sports Hall has been constructed and now requires licensing.
- 1.3 The Club currently benefits from an existing Premises Licence PL000461 (**Appendix B**), which is to be surrendered if this new licence application is deemed granted.

2. Application for the Grant of a Premises Licence

- 2.1 On 17th September 2014, the Licensing Section received an application (**Appendix A**) from Altrincham Association Football Club for the grant of a premises licence for the newly built Community Sports Hall located at Altrincham Football Club, The J Davidson Stadium, Moss Lane, Altrincham, Cheshire WA15 8AP.
- 2.2 The application requests the licensable activities as follows :

Community Sports Hall

Sale of Alcohol (On & Off) the premises from:

Monday to Thursday	10:00 to 23:00
Friday to Saturday	10:00 to 00:00
Sunday	12:00 to 22:30

Indoor Regulated Entertainment (Indoor Sports, Live Music, Recorded Music & Performance of Dance Indoors) from:

Monday to Thursday	09:00 to 23:00
Friday to Saturday	09:00 to 00:00
Sunday	09:00 to 22:30

The Stadium

Outdoor Regulated Entertainment (Recorded Music) from:

Monday to Thursday	09:00 to 23:00
Friday to Saturday	09:00 to 00:00
Sunday	09:00 to 22:30

- 2.3 The applicant has complied with all requirements under the application process including advertising the application in a newspaper, advertising by way of public notice at the premises and submitting a copy of the complete

application to all Responsible Authorities. The application is deemed to be correctly submitted.

3. Representations

3.1 Representations against the application have been received from local residents (**Appendix C1 – C2**).

3.2 The Members will be required to determine the relevance of the representations. When considering the relevance of the representations the Licensing Sub-Committee must apply three rules:

- i. the representation must be from a responsible authority or any other person;
- ii. it must not be repetitious, vexatious or frivolous; and
- iii. it must relate to one or more of the licensing objectives.

4. Licensing Objectives

4.1 The licensing objectives are:

- the prevention of crime and disorder;
- public safety;
- the prevention of public nuisance; and
- the protection of children from harm

4.1 The Committee should have regard to the Council's own Licensing Policy relating to the licensing objectives and to the Secretary of State's Guidance. (**Appendices D & E**).

5. Options

5.1 The Sub-Committee to take such steps as they consider necessary for the promotion of the Licensing Objectives in accordance with the provisions of subsection 18(4) of the Licensing Act 2003. The steps specified are:

5.1.1 To grant the licence subject to-

- Conditions consistent with the operating schedule accompanying the application modified to such extent as the authority considers necessary for the promotion of the licensing objectives, and;
- Any mandatory conditions which must be included under the Licensing Act 2003

5.1.2 to exclude from the scope of the licence any of the licensable activities to which the application relates;

- 5.1.3** to refuse to specify a person in the licence as the premises supervisor;
- 5.1.4** to reject the application.

- 5.2** The Sub-Committee is advised that any findings on any issues of fact should be on the balance of probability and any decision should be based on the individual merits of the application.
- 5.3** The Sub-Committee, in arriving at its decision, must have regard to relevant provisions of national guidance and its own statement of licensing policy and reasons should be given for any departure.

APPENDIX A

APPLICATION AND OPERATING SCHEDULE (including premises layout and location map)

PL54185
ULD/THET/1

AHWS 00087897
£190 chg



LA0394/14

LDO: 15/10

Application for a premises licence to be granted under the Licensing Act 2003

PLEASE READ THE FOLLOWING INSTRUCTIONS FIRST

Before completing this form please read the guidance notes at the end of the form. If you are completing this form by hand please write legibly in block capitals. In all cases ensure that your answers are inside the boxes and written in black ink. Use additional sheets if necessary. You may wish to keep a copy of the completed form for your records.

I/We Altrincham Association Football Club

(Insert name(s) of applicant)

apply for a premises licence under section 17 of the Licensing Act 2003 for the premises described in Part 1 below (the premises) and I/we are making this application to you as the relevant licensing authority in accordance with section 12 of the Licensing Act 2003

Part 1 – Premises Details

Postal address of premises or, if none, ordnance survey map reference or description The J Davidson Stadium Moss Lane			
Post town	Altrincham	Post code	WA15 8AP
Telephone number at premises (if any)	0161-928-1045		
Non-domestic rateable value of premises	£	20,000-00	

Part 2 - Applicant Details

Please state whether you are applying for a premises licence as
Please tick yes

- a) an individual or individuals * please complete section (A)
- b) a person other than an individual *
 - i. as a limited company please complete section (B)
 -

- ii. as a partnership please complete section (B)
- iii. as an unincorporated association or please complete section (B)
- iv. other (for example a statutory corporation) please complete section (B)
- c) a recognised club please complete section (B)
- d) a charity please complete section (B)
- e) the proprietor of an educational establishment please complete section (B)
- f) a health service body please complete section (B)
- g) a person who is registered under Part 2 of the Care Standards Act 2000 (c14) in respect of an independent hospital in Wales please complete section (B)
- ga) a person who is registered under Chapter 2 of Part 1 of the Health and Social Care Act 2008 (within the meaning of that Part) in an independent hospital in England please complete section (B)
- h) the chief officer of police of a police force in England and Wales please complete section (B)

* If you are applying as a person described in (a) or (b) please confirm:

Please tick yes

- o I am carrying on or proposing to carry on a business which involves the use of the premises for licensable activities, or
- o I am making the application pursuant to a
 - o statutory function or
 - o a function discharged by virtue of Her Majesty's prerogative

(A) INDIVIDUAL APPLICANTS (fill in as applicable)

Mr <input type="checkbox"/>	Mrs <input type="checkbox"/>	Miss <input type="checkbox"/>	Ms <input type="checkbox"/>	Other Title (for example, Rev)	
Surname			First names		
I am 18 years old or over					<input type="checkbox"/> Please tick yes
Current postal address if different from premises address					
Post Town				Postcode	
Daytime contact telephone number					
E-mail address (optional)					

--	--

SECOND INDIVIDUAL APPLICANT (if applicable)

Mr <input type="checkbox"/>	Mrs <input type="checkbox"/>	Miss <input type="checkbox"/>	Ms <input type="checkbox"/>	Other Title (for example, Rev)	
Surname			First names		
I am 18 years old or over				<input type="checkbox"/> Please tick yes	
Current postal address if different from premises address					
Post Town				Postcode	
Daytime contact telephone number					
E-mail address (optional)	orumah@yahoo.com				

(B) OTHER APPLICANTS

Please provide name and registered address of applicant in full. Where appropriate please give any registered number. In the case of a partnership or other joint venture (other than a body corporate), please give the name and address of each party concerned.

Name Altrincham Association Football Club
Address The J Davidson Stadium Moss Lane Altrincham Cheshire WA15 8AP
Registered number (where applicable) 176333
Description of applicant (for example, partnership, company, unincorporated association etc.) Football Club – Limited Company
Telephone number (if any) 0161-928-1045

E-mail address (optional)
altrinchamprog@yahoo.co.uk

Part 3 Operating Schedule

When do you want the premises licence to start?

Day		Month		Year	

If you wish the licence to be valid only for a limited period, when do you want it to end?

Day		Month		Year	
±	±	±	±	±	±

Please give a general description of the premises (please read guidance note1)

The premises are a "New Build" Community Sports Hall adjacent to our existing bar which is beneath the Football Club's Main Stand.
The Bar will be situated along one of the sides of the Hall and customers/users will consume alcohol/drinks within the confines of the Hall

If 5,000 or more people are expected to attend the premises at any one time, please state the number expected to attend.

What licensable activities do you intend to carry on from the premises?

(Please see sections 1 and 14 of the Licensing Act 2003 and Schedules 1 and 2 to the Licensing Act 2003)

Provision of regulated entertainment

Please tick yes

- | | |
|---|-------------------------------|
| a) plays (if ticking yes, fill in box A) | <input type="checkbox"/> |
| b) films (if ticking yes, fill in box B) | <input type="checkbox"/> |
| c) indoor sporting events (if ticking yes, fill in box C) | X
<input type="checkbox"/> |
| d) boxing or wrestling entertainment (if ticking yes, fill in box D) | <input type="checkbox"/> |
| e) live music (if ticking yes, fill in box E) | X
<input type="checkbox"/> |
| f) recorded music (if ticking yes, fill in box F) | X
<input type="checkbox"/> |
| g) performances of dance (if ticking yes, fill in box G) | X
<input type="checkbox"/> |
| h) anything of a similar description to that falling within (e), (f) or (g) (if ticking yes, fill in box H) | <input type="checkbox"/> |

Provision of late night refreshment (if ticking yes, fill in box I)

Supply of alcohol (if ticking yes, fill in box J)

In all cases complete boxes K, L and M

A

Plays Standard days and timings (please read guidance note 6)			Will the performance of a play take place indoors or outdoors or both – please tick (please read guidance note 2)	Indoors	<input type="checkbox"/>
Day	Start	Finish		Outdoors	<input type="checkbox"/>
Mon			Please give further details here (please read guidance note 3)	Both	<input type="checkbox"/>
Tue					
Wed			State any seasonal variations for performing plays (please read guidance note 4)		
Thur					
Fri			Non standard timings. Where you intend to use the premises for the performance of plays at different times to those listed in the column on the left, please list (please read guidance note 5)		
Sat					
Sun					

B

Films Standard days and timings (please read guidance note 6)			<u>Will the exhibition of films take place indoors or outdoors or both – please tick</u> (please read guidance note 2)	Indoors	<input type="checkbox"/>
				Outdoors	<input type="checkbox"/>
				Both	<input type="checkbox"/>
Day	Start	Finish	<u>Please give further details here</u> (please read guidance note 3)		
Mon					
Tue			<u>State any seasonal variations for the exhibition of films</u> (please read guidance note 4)		
Wed					
Thur			<u>Non standard timings. Where you intend to use the premises for the exhibition of films at different times to those listed in the column on the left, please list</u> (please read guidance note 5)		
Fri					
Sat					
Sun					

C

Indoor sporting events Standard days and timings (please read guidance note 6)			Please give further details (please read guidance note 3) Various indoor activities – Zumba, Martial arts training, Dance
Day	Start	Finish	
Mon	9.00	23.00	State any seasonal variations for indoor sporting events (please read guidance note 4) N/A Non standard timings. Where you intend to use the premises for indoor sporting events at different times to those listed in the column on the left, please list (please read guidance note 5) N/A
Tue	9.00	23.00	
Wed	9.00	23.00	
Thur	9.00	23.00	
Fri	9.00	24.00	
Sat	9.00	24.00	
Sun	9.00	22.30	

D

Boxing or wrestling entertainments Standard days and timings (please read guidance note 6)			Will the boxing or wrestling entertainment take place indoors or outdoors or both – please tick (please read guidance note 2)	Indoors	<input type="checkbox"/>
				Outdoors	<input type="checkbox"/>
				Both	<input type="checkbox"/>
Day	Start	Finish	Please give further details here (please read guidance note 3)		
Mon					
Tue			State any seasonal variations for boxing or wrestling entertainment (please read guidance note 4)		
Wed					
Thur			Non standard timings. Where you intend to use the premises for boxing or wrestling entertainment at different times to those listed in the column on the left, please list (please read guidance note 5)		
Fri					
Sat					
Sun					

E

Live music Standard days and timings (please read guidance note 6)			Will the performance of live music take place indoors or outdoors or both – please tick (please read guidance note 2)	Indoors	<input checked="" type="checkbox"/>
				Outdoors	<input type="checkbox"/>
				Both	<input type="checkbox"/>
Day	Start	Finish	Please give further details here (please read guidance note 3) Live bands as described below – amplified music		
Mon	09.00	23.00			
Tue	09.00	23.00			
Wed	09.00	23.00			
			State any seasonal variations for the performance of live music (please read guidance note 4) From the end of permitted hours on New Year's Eve to the start of permitted hours on New Year's Day		
Thur	09.00	23.00			
Fri	09.00	00.00	Non standard timings. Where you intend to use the premises for the performance of live music at different times to those listed in the column on the left, please list (please read guidance note 5) Occasional live bands to perform within the Hall for functions which have been booked at the venue – primarily on Friday and Saturday nights.		
Sat	09.00	00.00			
Sun	09.00	22.30			

F

Recorded music Standard days and timings (please read guidance note 6)			Will the playing of recorded music take place <u>indoors or outdoors or both – please tick</u> (please read guidance note 2)	Indoors	<input type="checkbox"/>
Day	Start	Finish		Outdoors	<input type="checkbox"/>
Mon	9.00	23.00	Please give further details here (please read guidance note 3) Tannoy music on matchdays around the ground – half an hour before game and at half time. Background music inside the Hall – low volume	Both	<input checked="" type="checkbox"/>
Tue	9.00	23.00			
Wed	9.00	23.00	State any seasonal variations for the playing of recorded music (please read guidance note 4) From the end of permitted hours on New Year's Eve to the start of permitted hours on New Year's Day		
Thur	9.00	23.00			
Fri	9.00	24.00	Non standard timings. Where you intend to use the premises for the playing of recorded music at different times to those listed in the column on the left, please list (please read guidance note 5) Occasional outdoor music for booked events at the Football Ground and Charity games		
Sat	9.00	24.00			
Sun	9.00	22.30			

G

Performances of dance Standard days and timings (please read guidance note 6)			Will the performance of dance take place indoors or outdoors or both – please tick (please read guidance note 2)	Indoors	<input checked="" type="checkbox"/>
				Outdoors	<input type="checkbox"/>
				Both	<input type="checkbox"/>
Day	Start	Finish	<u>Please give further details here</u> (please read guidance note 3) Indoor dance classes – timings as and when booked		
Mon	9.00	23.00			
Tue	9.00	23.00	<u>State any seasonal variations for the performance of dance</u> (please read guidance note 4) From the end of permitted hours on New Year's Eve to the start of permitted hours on New Year's Day		
Wed	9.00	23.00			
Thur	9.00	23.00	<u>Non standard timings. Where you intend to use the premises for the performance of dance at different times to those listed in the column on the left, please list</u> (please read guidance note 5)		
Fri	9.00	24.00			
Sat	9.00	24.00			
Sun	9.00	22.30			

H

<p>Anything of a similar description to that falling within (e), (f) or (g) Standard days and timings (please read guidance note 6)</p>			<p><u>Please give a description of the type of entertainment you will be providing</u></p>		
Day	Start	Finish	<p><u>Will this entertainment take place indoors or outdoors or both – please tick</u> (please read guidance note 2)</p>	Indoors	<input type="checkbox"/>
Mon				Outdoors	<input type="checkbox"/>
				Both	<input type="checkbox"/>
Tue			<p><u>Please give further details here</u> (please read guidance note 3)</p>		
Wed					
Thur			<p><u>State any seasonal variations for entertainment of a similar description to that falling within (e), (f) or (g)</u> (please read guidance note 4)</p>		
Fri					
Sat			<p><u>Non standard timings. Where you intend to use the premises for the entertainment of a similar description to that falling within (e), (f) or (g) at different times to those listed in the column on the left, please list</u> (please read guidance note 5)</p>		
Sun					

I

Late night refreshment Standard days and timings (please read guidance note 6)			Will the provision of late night refreshment take place indoors or outdoors or both – please tick (please read guidance note 2)	Indoors	<input type="checkbox"/>
				Outdoors	<input type="checkbox"/>
				Both	<input type="checkbox"/>
Day	Start	Finish	<u>Please give further details here</u> (please read guidance note 3)		
Mon					
Tue			<u>State any seasonal variations for the provision of late night refreshment</u> (please read guidance note 4)		
Wed					
Thur			<u>Non standard timings. Where you intend to use the premises for the provision of late night refreshment at different times, to those listed in the column on the left, please list</u> (please read guidance note 5)		
Fri					
Sat					
Sun					

K

Please highlight any adult entertainment or services, activities, other entertainment or matters ancillary to the use of the premises that may give rise to concern in respect of children (please read guidance note 8)

None

L

Hours premises are open to the public Standard days and timings (please read guidance note 6)			State any seasonal variations (please read guidance note 4) None From the end of permitted hours on New Year's Eve to the start of permitted hours on New Year's Day
Day	Start	Finish	Non standard timings. Where you intend the premises to be open to the public at different times from those listed in the column on the left, please list (please read guidance note 5)
Mon	9.00	00.00	
Tue	9.00	00.00	
Wed	9.00	00.00	
Thur	9.00	00.00	
Fri	9.00	00.30	
Sat	9.00	00.30	
Sun	9.00	23.00	

M Describe the steps you intend to take to promote the four licensing objectives:

a) General – all four licensing objectives (b,c,d,e) (please read guidance note 9)

We are very respectful of our neighbours and will do our utmost to ensure that the use of the Community Sports Hall will not impinge on their daily lives with any undue noise or disturbance. Many of our users will be from the neighbourhood.

b) The prevention of crime and disorder

CCTV will be installed around the premises and video entry to the car park to monitor activities. Staff will be trained to ensure immediate response to any act of crime and disorder

c) Public safety

Full risk assessment of building and any activities to take place therein will be carried out. Accident and incident books to be used onsite

d) The prevention of public nuisance

Notices will be displayed to ensure users of the Community Sports Hall respect our neighbours especially when leaving the premises after activities and booked functions. Those non-adhering to these warning will be banned from using the facilities.

Noise from music and associated sources (including DJ's and amplified voices) must not be audible to such an extent that it constitutes a nuisance at any noise sensitive properties.

All external doors and windows shall be kept closed when there is regulated entertainment except in the event of an emergency or access or egress into the premises.

e) The protection of children from harm

Via Risk Assessment – Hall will be child friendly – therefore avoiding unnecessary accidents occurring

Please tick yes

- I have made or enclosed payment of the fee
- I have enclosed the plan of the premises
- I have sent copies of this application and the plan to responsible authorities and others where applicable
- I have enclosed the consent form completed by the individual I wish to be premises supervisor, if applicable
- I understand that I must now advertise my application
- I understand that if I do not comply with the above requirements my application will be rejected

IT IS AN OFFENCE, LIABLE ON CONVICTION TO A FINE UP TO LEVEL 5 ON THE STANDARD SCALE, UNDER SECTION 158 OF THE LICENSING ACT 2003 TO MAKE A FALSE STATEMENT IN OR IN CONNECTION WITH THIS APPLICATION

Part 4 – Signatures (please read guidance note 10)

Signature of applicant or applicant's solicitor or other duly authorised agent (See guidance note 11). **If signing on behalf of the applicant please state in what capacity.**

Signature	Grahame Rowley 
Date	17 th September 2014
Capacity	Chairman – Altrincham Football Club

For joint applications signature of 2nd applicant or 2nd applicant's solicitor or other authorised agent. (please read guidance note 12). **If signing on behalf of the applicant please state in what capacity.**

Signature	
Date	
Capacity	

Contact name (where not previously given) and postal address for correspondence associated with this application (please read guidance note 13)

Mr Grahame Rowley
Altrincham Association Football Club
The J D Stadium,
Moss Lane

Post town	Altrincham	Post code	WA15 8AP
------------------	------------	------------------	----------

Telephone number (if any)	0161-928-1045 or 07720-606897
----------------------------------	-------------------------------

If you would prefer us to correspond with you by e-mail your e-mail address (optional) altrinchamprog@yahoo.co.uk

Notes for Guidance

1. Describe the premises. For example the type of premises, its general situation and layout and any other information which could be relevant to the licensing objectives. Where your application includes off-supplies of alcohol and you intend to provide a place for consumption of these off-supplies you must include a description of where the place will be and its proximity to the premises.
2. Where taking place in a building or other structure please tick as appropriate. Indoors may include a tent.
3. For example the type of activity to be authorised, if not already stated, and give relevant further details, for example (but not exclusively) whether or not music will be amplified or unamplified.
4. For example (but not exclusively), where the activity will occur on additional days during the summer months.
5. For example (but not exclusively), where you wish the activity to go on longer on a particular day e.g. Christmas Eve.
6. Please give timings in 24 hour clock (e.g. 16:00) and only give details for the days of the week when you intend the premises to be used for the activity.
7. If you wish people to be able to consume alcohol on the premises please tick on, if you wish people to be able to purchase alcohol to consume away from the premises please tick off. If you wish people to be able to do both please tick both.
8. Please give information about anything intended to occur at the premises or ancillary to the use of the premises which may give rise to concern in respect of children, regardless of whether you intend children to have access to the premises, for example (but not exclusively) nudity or semi-nudity, films for restricted age groups, the presence of gaming machines.
9. Please list here steps you will take to promote all four licensing objectives together.
10. The application form must be signed.
11. An applicant's agent (for example solicitor) may sign the form on their behalf provided that they have actual authority to do so.
12. Where there is more than one applicant, both applicants or their respective agents must sign the application form.
13. This is the address which we shall use to correspond with you about this application.

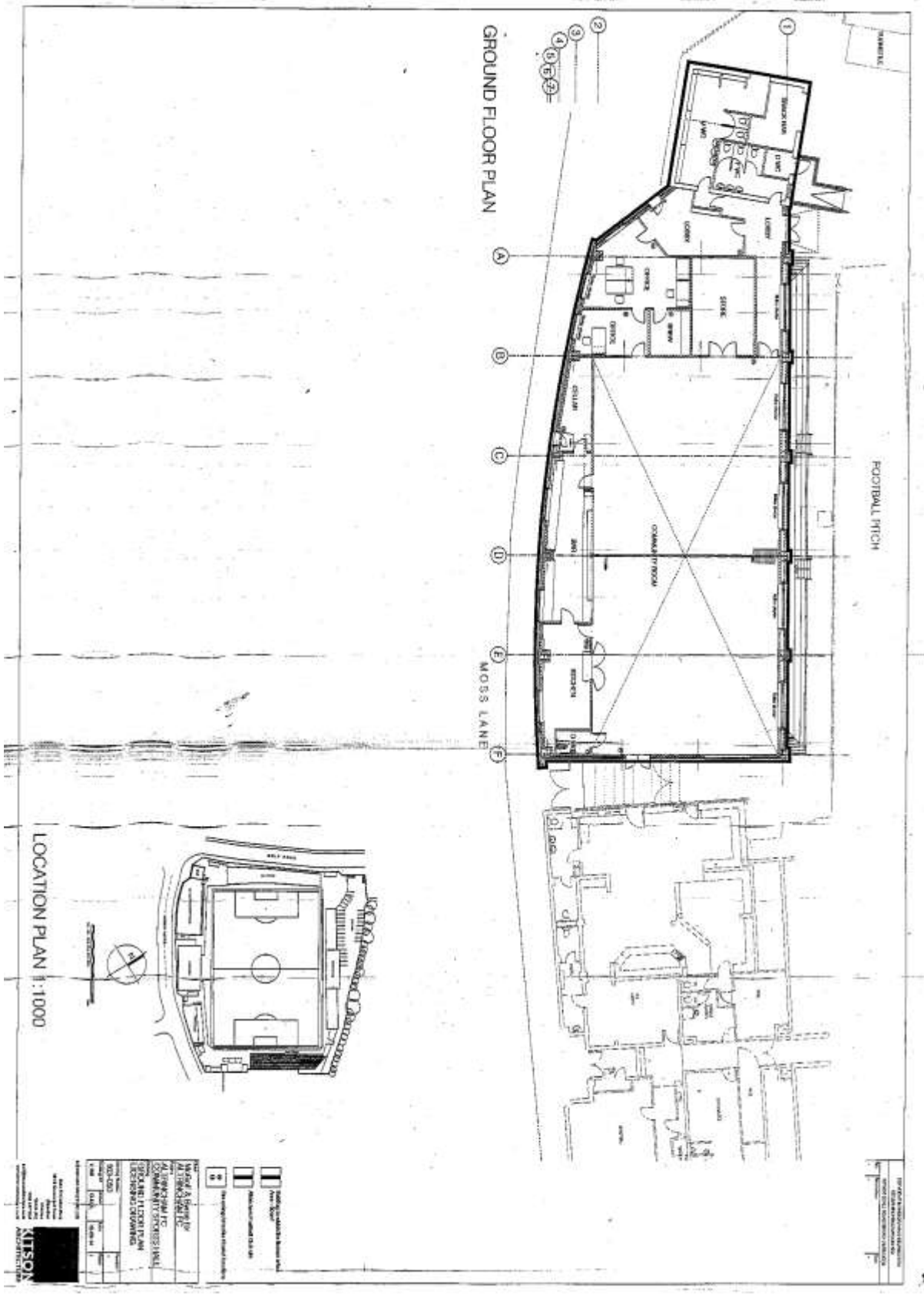

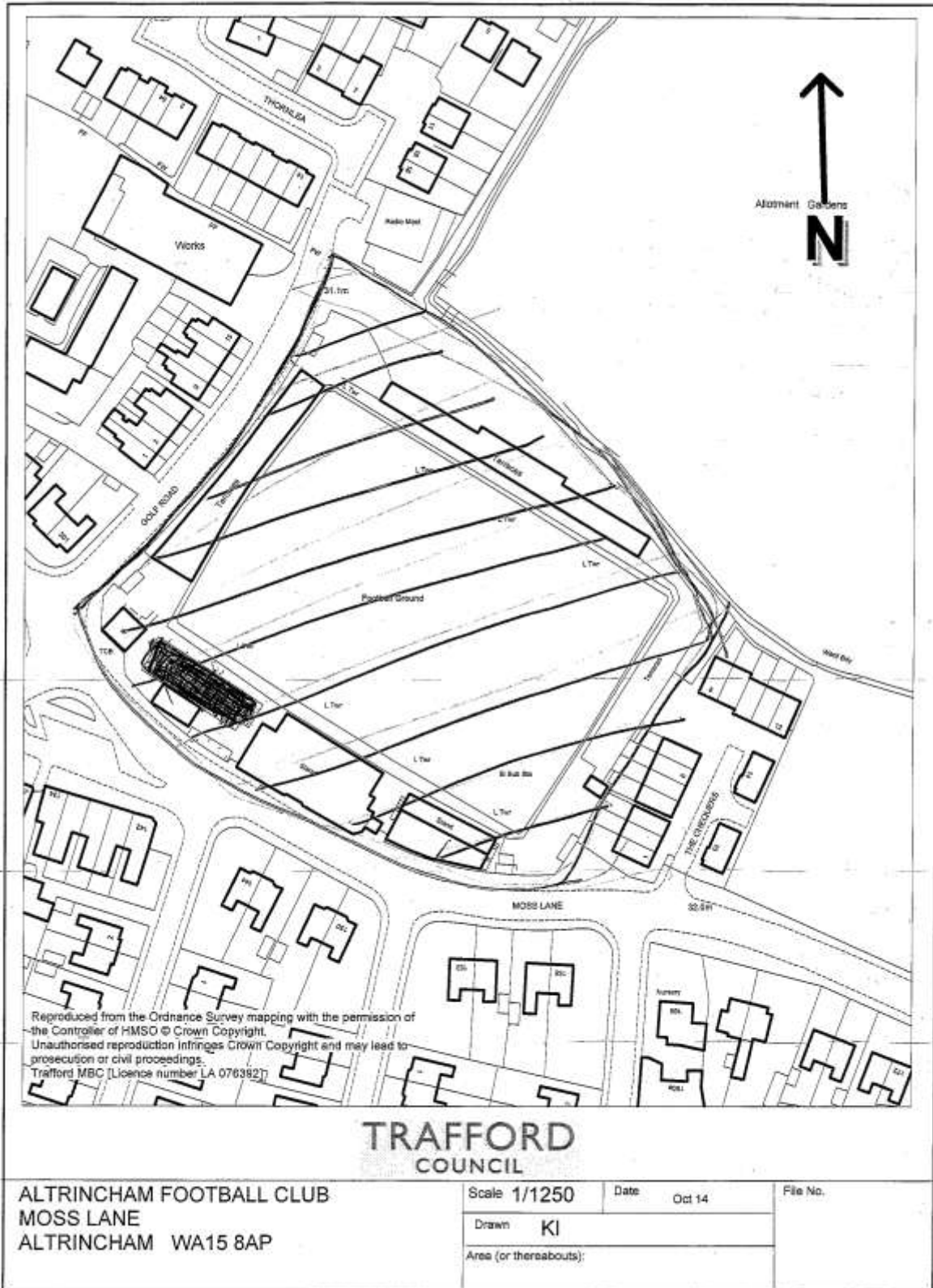

APPENDIX B

CURRENT PREMISES LICENCE

PL000461

Part 1 - Premises Details

POSTAL ADDRESS OF PREMISES, OR IF NONE, ORDINANCE SURVEY MAP REFERENCE OR DESCRIPTION**Altrincham Football Club**

Moss Lane, Altrincham, Cheshire, WA15 8AP

Telephone 0161 928 1045

WHERE THE LICENCE IS TIME LIMITED THE DATES

Not applicable

LICENSABLE ACTIVITIES AUTHORISED BY THE LICENCE

- any playing of recorded music
- entertainment facilities for dancing
- the sale by retail of alcohol

THE TIMES THE LICENCE AUTHORISES THE CARRYING OUT OF LICENSABLE ACTIVITIES

Activity (and Area if applicable)	Description	Time From	Time To
F. Playing of recorded music (Indoors)	Monday to Thursday	10:00am	11:00pm
	Friday to Saturday	10:00am	Midnight
	Sunday	Noon	10:30pm
J. Provision of facilities for dancing (Indoors)	Monday to Thursday	10:00am	11:00pm
	Friday to Saturday	10:00am	Midnight
	Sunday	Noon	10:30pm
M. The sale by retail of alcohol for consumption ON the premises only	Monday to Thursday	10:00am	11:00pm
	Friday to Saturday	10:00am	Midnight
	Sunday	Noon	10:30pm
	Good Friday	Noon	10:30pm
	Christmas Day	Noon	3:00pm
	Christmas Day	7:00pm	10:30pm

THE OPENING HOURS OF THE PREMISES

Description	Time From	Time To
-------------	-----------	---------

Licensing Act 2003

Premises Licence

PL000461

THE OPENING HOURS OF THE PREMISES - continued ...

Description	Time From	Time To
Monday to Thursday	10:00am	11:30pm
Friday to Saturday	10:00am	12:30am
Sunday	Noon	11:00pm

WHERE THE LICENCE AUTHORISES SUPPLIES OF ALCOHOL WHETHER THESE ARE ON AND / OR OFF SUPPLIES

- M. The sale by retail of alcohol for consumption ON the premises only

Part 2

NAME, (REGISTERED) ADDRESS, TELEPHONE NUMBER AND EMAIL (WHERE RELEVANT) OF HOLDER OF PREMISES LICENCE

Altrincham Association Football Club

Moss Lane, Altrincham, Cheshire, WA15 8AP

REGISTERED NUMBER OF HOLDER, FOR EXAMPLE COMPANY NUMBER, CHARITY NUMBER (WHERE APPLICABLE)

Altrincham Association Football Club

176333

NAME, ADDRESS AND TELEPHONE NUMBER OF DESIGNATED PREMISES SUPERVISOR WHERE THE PREMISES LICENCE AUTHORISES THE SUPPLY OF ALCOHOL

Thomas George Boyd HESLOP

PERSONAL LICENCE NUMBER AND ISSUING AUTHORITY OF PERSONAL LICENCE HELD BY DESIGNATED PREMISES SUPERVISOR WHERE THE PREMISES LICENCE AUTHORISES FOR THE SUPPLY OF ALCOHOL

Licence No. PA0418

Issued by Trafford

ANNEXES

ANNEX 1 - MANDATORY CONDITIONS

1. Alcohol may only be sold and/or supplied for consumption on the premises in those areas coloured pink on the plans attached.
2. In that part of the premises coloured pink on the said plans alcohol shall only be sold and/or sold to persons (a) attending matches at the invitation of persons, firms or companies sponsoring games played on the ground on the day in question and/or (b) persons attending private or pre-arranged functions or events.
3. No off sales.
4. No occasional licences.

ANNEXES continued ...

5. Alcohol shall not be sold, supplied or consumed on the premises during the half time period of any football league or cup match played on the ground of the club save and except and within the area marked on the plan.
6. Alcohol shall only be sold or supplied in plastic containers in the period prior to the commencement of any football league or cup match played at the ground.
7. The occupancy of the licensed area shall not exceed 240 persons including staff.
8. In addition to the hours specified on the attached licence the sale or supply of alcohol may be permitted as follows:

On New Year's Eve from the end of licensing hours on New Year's Eve to the start of licensing hours on the following day (or, if there are no licensing hours on the following day, midnight on 31st December)
9. The above restrictions do not prohibit:
 - (a) during the first twenty minutes after the above hours the consumption of the alcohol on the premises;
 - (b) during the first twenty minutes after the above hours, the taking of the alcohol from the premises unless the alcohol is supplied or taken in an open vessel;
 - (c) during the first thirty minutes after the above hours the consumption of the alcohol on the premises by persons taking meals there if the alcohol was supplied for consumption as ancillary to meals;
 - (d) consumption of alcohol on the premises or the taking of sale or supply of alcohol to any person residing in the licensed premises;
 - (e) the ordering of alcohol to be consumed off the premises, or the dispatch by the vendor of the alcohol so ordered;
 - (f) the sale of alcohol to a trader or club for the purposes of the trade or club;
 - (g) the sale or supply of alcohol to any canteen or mess, being a canteen in which the sale or supply of alcohol is carried out under the authority of the Secretary of State or an authorised mess of members of Her Majesty's naval, military or air forces;
 - (h) the taking of alcohol from the premises by a person residing there; or
 - (i) the supply of alcohol for consumption on the premises to any private friends of a person residing there who are bona fide entertained by him at his own expense, or the consumption of the alcohol by persons so supplied; or
 - (j) the supply of alcohol for consumption on the premises to persons employed there for the purposes of the business carried on by the holder of the licence, or the consumption of liquor so supplied, if the liquor is supplied at the expense of their employer or of the person carrying on or in charge of the business on the premises.
10. No person under fourteen shall be in the bar of the licensed premises during the permitted hours unless one of the following applies:
 - (a) He is the child of the holder of the premises licence.
 - (b) He resides in the premises, but is not employed there.

ANNEXES continued...

- (c) He is in the bar solely for the purpose of passing to or from some part of the premises which is not a bar and to or from which there is no other convenient means of access or egress.
 - (d) The bar is in railway refreshment rooms or other premises constructed, fitted and intended to be used bona fide for any purpose to which the holding of the licence is ancillary
11. In this condition "bar" includes any place exclusively or mainly used for the consumption of alcohol. But an area is not a bar when it is usual for it to be, and it is, set apart for the service of table meals and alcohol is only sold or supplied to persons as an ancillary to their table meals.
12. Alcohol shall not be sold or supplied unless it is paid for before or at the time when it is sold or supplied, except alcohol sold or supplied:
- a) with and for consumption at a meal supplied at the same time, consumed with the meal and paid for together with the meal;
 - b) for consumption by a person residing in the premises or his guest and paid for together with his accommodation;
 - c) to a canteen or mess.
13. No supply of alcohol may be made under the premises licence -
- (a) at a time when there is no designated premises supervisor in respect of the premises, or
 - (b) at a time when the designated premises supervisor does not hold a personal licence or his personal licence is suspended.
14. Every supply of alcohol under the premises licence must be made or authorised by a person who holds a personal licence.
15. Where the premises licence includes a condition that at specified times one or more individuals must be at the premises to carry out a security activity, each such individual must be licensed by the Security Industry Authority.

ANNEX 2 - CONDITIONS CONSISTENT WITH THE OPERATING SCHEDULE

None

ANNEX 3 - CONDITIONS ATTACHED AFTER A HEARING BY THE LICENSING AUTHORITY

1. Noise from music and associated sources (including DJ's and amplified voices) must not be audible to such an extent that it constitutes a nuisance at any noise sensitive properties.
2. All external doors and windows shall be kept closed when there is regulated entertainment except in the event of an emergency or access or egress into the premises.
3. There shall be placed at all exits from the premises in a place where they can be seen and easily read by the

Licensing Act 2003

Premises Licence

PL000461

ANNEXES continued...

public, (or member and their guests) notices requiring customers to leave the premises and the area quietly. (Note this may also include a reference to vehicles).



Signature of Authorised Officer

APPENDIX C1

REPRESENTATION

14 The Chequers

Moss Lane

Hale

Altrincham

Cheshire

WA15 8ZL

7th October 2014

Dear Sirs.

Re: Licencing Application LA0394/14 - Altrincham Football Club

I wish to register my objection to the application for the New Premises Licence for the Sale of Alcohol (on & off) and the Regulated Entertainment (indoors & outdoors), as listed on the application.

The reasons being;

- The proximity of the premises to a very residential area;
- The lack of responsible parking by visitors to the premises not using the car park, but parking on pavements and blocking pedestrian use/ causing blockages to the smooth flow of traffic/parking across driveways;
- The litter/broken glass caused by visitors and not cleared up;
- Noise late at night during the working week in an area where many residents have young children and also work so need to be able to enjoy a reasonable night's sleep;
- This is an area of Altrincham that attracts younger families being a slightly more affordable area and their enjoyment will be interrupted by the proposed licences being granted.

It would be wrong to grant entertainment and alcohol licences to allow such premises to be open until as late as 11 pm during the working week as per the above.

It would be far more reasonable for any licence to be on a 'special' licence basis/adhoc application basis to allow for functions over weekends.

At no time when the original notification of the premises at the football ground being developed were the residents notified of the proposed licences being applied for.

I have no doubt that had the local residents been so advised they would have objected to the planning application.

I would also draw to the Trafford licencing board that the only visible notices in relation to the licencing applications have been obscured by scaffolding and therefore I do not

consider the football club has discharged its duty in relation to notifying people of the applications.

I look forward to receiving confirmation that the objection has been received my email address is [REDACTED]

Yours faithfully

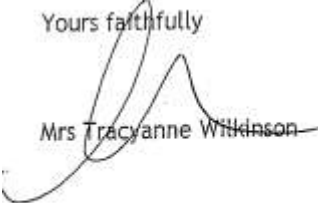
Mrs Tracyanne Wilkinson

APPENDIX C2

REPRESENTATION

From: [REDACTED]
Sent: 13 October 2014 13:05
To: Licensing
Subject: LA0394/14

I would like to object to the Regulated Entertainment part of the application by Altrincham Football Club. I am not happy about there being outdoor entertainment in the late evening included in the application, because I have a young family and I work Monday to Friday. The proposed finishing times are too late at night, because my house backs directly onto the football ground and we would be disturbed. Anything up to a maximum of 9pm (which it is currently with football matches) is fine.

Kind regards
Elizabeth Stagg
2 The Chequers

HAWE
ALTRINCHAM
CHESHIRE
WA15 8ZL

APPENDIX D

Secretary of State's Guidance

PUBLIC NUISANCE

- 2.32 The 2003 Act requires licensing authorities (following receipt of relevant representations) and responsible authorities, through representations, to make judgements about what constitutes public nuisance and what is necessary to prevent it in terms of conditions attached to specific premises licences and club premises certificates. It is therefore important that in considering the promotion of this licensing objective, licensing authorities and responsible authorities focus on impacts of the licensable activities at the specific premises on persons living and working (including doing business) in the vicinity that are disproportionate and unreasonable. The issues will mainly concern noise nuisance, light pollution, noxious smells and litter.
- 2.33 Public nuisance is given a statutory meaning in many pieces of legislation. It is however not narrowly defined in the 2003 Act and retains its broad common law meaning. It is important to remember that the prevention of public nuisance could therefore include low-level nuisance perhaps affecting a few people living locally as well as major disturbance affecting the whole community. It may also include in appropriate circumstances the reduction of the living and working amenity and environment of interested parties (as defined in the 2003 Act) in the vicinity of licensed premises.²
- 2.34 Conditions relating to noise nuisance will normally concern steps necessary to control the levels of noise emanating from premises. This might be achieved by a simple measure such as ensuring that doors and windows are kept closed after a particular time in the evening to more sophisticated measures like the installation of acoustic curtains or rubber speaker mounts. Any conditions necessary to promote the prevention of public nuisance should be tailored to the style and characteristics of the specific premises. Licensing authorities should be aware of the need to avoid unnecessary or disproportionate measures that could deter events that are valuable to the community, such as live music. Noise limiters, for example, are very expensive to purchase and install and are likely to be a considerable burden for smaller venues.
- 2.35 As with all conditions, it will be clear that conditions relating to noise nuisance may not be necessary in certain circumstances where the provisions of the Environmental Protection Act 1990, the Noise Act 1996, or the Clean Neighbourhoods and Environment Act 2005 adequately protect those living in

the vicinity of the premises. But as stated earlier in this Guidance, the approach of licensing authorities and responsible authorities should be one of prevention and when their powers are engaged, licensing authorities should be aware of the fact that other legislation may not adequately cover concerns raised in relevant representations and additional conditions may be necessary.

- 2.36 Where applications have given rise to representations, any necessary and appropriate conditions should normally focus on the most sensitive periods. For example, music noise from premises usually occurs from mid-evening until either late evening or early morning when residents in adjacent properties may be attempting to go to sleep or are sleeping. In certain circumstances, conditions relating to noise in the immediate vicinity of the premises may also prove necessary to address any disturbance anticipated as customers enter and leave.
- 2.37 Measures to control light pollution will also require careful thought. Bright lighting outside premises considered necessary to prevent crime and disorder may itself give rise to light pollution for some neighbours. Applicants, licensing authorities and responsible authorities will need to balance these issues.
- 2.38 In the context of preventing public nuisance, it is again essential that conditions are focused on measures within the direct control of the licence holder or club. Conditions relating to public nuisance caused by the anti-social behaviour of customers once they are beyond the control of the licence holder, club or premises management cannot be justified and will not serve to promote the licensing objectives.
- 2.39 Beyond the vicinity of the premises, these are matters for personal responsibility of individuals under the law. An individual who engages in anti-social behaviour is accountable in their own right. However, it would be perfectly reasonable for a licensing authority to impose a condition, following relevant representations, that requires the licence holder or club to place signs at the exits from the building encouraging patrons to be quiet until they leave the area and to respect the rights of people living nearby to a peaceful night.
- 2.40 The cumulative effects of litter in the vicinity of premises carrying on licensable activities can cause public nuisance. For example, it may be appropriate and necessary for a condition of a licence to require premises serving customers from take-aways and fast food outlets from 11.00pm to provide litter bins in the vicinity of the premises in order to prevent the accumulation of litter. Such conditions may be necessary and appropriate in circumstances where customers late at night may have been consuming alcohol and be inclined to carelessness and anti-social behaviour.

APPENDIX E

Trafford Council – Licensing Policy 2011-2014

7.0 LICENCE OBJECTIVE – THE PREVENTION OF PUBLIC NUISANCE

7.1 Licensed premises have a significant potential to impact adversely on communities through public nuisances which can arise from their operation.

The Council recognises the need to prevent public nuisance to residents, visitors and other businesses from the potential consequence of the operation of licensed premises, whilst balancing the rights of licensed premises to develop their business potential.

7.2 Public nuisance in this context includes such issues as noise and disturbance, light pollution, odour, vermin and pest infestations, accumulations of refuse and litter, and anti-social behaviour, where these matters impact on those living, working or otherwise engaged in normal activity in an area.

7.3 The Council, however, recognises that licensing law is not a mechanism for the general control of anti-social behaviour by individuals once they are away from the premises and therefore beyond the direct control of the individual, club or business holding the licence.

7.4 Applicants will be expected to demonstrate in their operating schedule that suitable and sufficient measures have been identified and will be implemented and maintained with the intention of preventing public nuisance.

7.5 In considering applications, the Council will expect to see evidence that the applicant has identified matters that impact on the likelihood of public nuisance and that these matters have been addressed in the operating schedule. Such measures may include:

- Measures taken or proposed to be taken to prevent noise and vibration escaping from the premises or the immediate vicinity of the premises and including any outside areas (including smoking areas) bearing in mind the location of premises and proximity to residential and other noise sensitive premises (e.g. hospitals, hospices and places of worship); This would include music, ventilation equipment noise and human voices, whether or not amplified;
- Measures taken or proposed for management and supervision of the premises and associated open areas to minimise unreasonable disturbance by customers and staff arriving or departing from the premises and delivery of goods and services.
- Control of opening hours for all or part (e.g. garden areas) of the premises

- Measures taken to control light to ensure that it does not stray outside the boundary of the premises such as to give rise to problems to residents in the vicinity
- Steps taken to lessen the impact of parking in the local vicinity
- Measures taken to prevent someone who has consumed excess alcohol from entering the premises and to manage individuals on the premises who have consumed excess alcohol
- Management arrangements for collection and disposal of litter and refuse, and the control of pests
- Arrangements for ensuring that adequate and suitably maintained sanitary provision and washing facilities are provided for the number of people expected to attend any premises or events
- A 'wind down time' after the last service of alcohol, during which time the venue may offer for sale non-alcohol beverages
- A 'last admission time' policy
- Management arrangements for any proposed use of bonfires, fireworks and other pyrotechnics.

7.6 The extent to which the above matters need to be addressed will be dependent on the nature of the area where the premises are situated, the type of premises concerned, the licensable activities to be provided, operational procedures and the needs of the local community. In general, however, the Council will expect more comprehensive measures to be in place at late night entertainment venues or in premises with a history of public nuisance issues.

7.7 The Council will have regard to representations from the responsible authorities to determine if measures proposed are sufficient to reduce the risk of public nuisance. Where representations indicate that any matter has not been addressed sufficiently to prevent public nuisance the applicant will be expected to demonstrate that the issues can be satisfactorily addressed before the Council will grant an application for a licence or a variation.

7.8 Where appropriate the applicant will be expected to propose practical steps to prevent disturbance to local residents and to have regard to the "Good Practice Guide on the Control of Noise from Pubs and Clubs" produced by the Institute of Acoustics. Where noise has been identified as a potential problem by the applicant or Council officers, then the Council would expect the applicant to detail the measures proposed to address this issue within the operating schedule. Noise could relate not only to music but also from air handling equipment or from patrons. There are a number of practical ways in which sound leakage can be addressed, such as:

- Keeping doors and windows closed and providing adequate mechanical ventilation or, if necessary, air conditioning
- Reducing sound levels and installing a sound limiting device to prevent sound exceeding the appropriate level
- Installing soundproofing measures to contain sound and vibration.

7.9 In premises where patrons leave the premises particularly late at night or early in the morning, the Council will expect the applicant to have included in the operating schedule practical steps for reducing noise disturbance, such as:

- Erecting prominent notices at the exits to premises asking customers to leave quietly and not to slam car doors, and to respect the rights of nearby residents
- At appropriate times making loudspeaker announcements to the same effect
- Instructing door staff to ask customers leaving the premises to leave the area quietly
- Reducing the volume of music towards the end of the evening and where appropriate playing quieter, more soothing music as the evening winds down
- Banning from the premises people who regularly leave in a noisy manner
- The supervision of any queues formed late in the evening so as to keep noise and disturbance to a minimum.

7.10 Where relevant representations have been received, conditions may be imposed which include restrictions on the times when music or other licensable activities may take place and may include technical restrictions on sound levels at the premises.

7.11 In considering an application, the Council will take into account previous noise and nuisance complaints, and the ability/willingness of the licensee to deal with such complaints.

This page is intentionally left blank